



FALL PROTECTION

 Quebee



QB-PN-11

QB Full Body Harness

Description

- **Attachment Elements:** A dorsal attachment D-Ring for fall arrest
- **Adaptability:** Adjustable thigh-straps; sliding plates for easy chest-strap adjustment
- **Convenience:** Shoulder and thigh-straps are differentiated by a dual-color scheme
- **Ergonomics:** Ideally positioned sit-strap for extended comfort

Compliance

EN361:2002, SS528:2006



QB-PN-23

QB Full Body Harness

Description

- **Attachment Elements:** 2 shoulder attachment D-Rings, 1 chest attachment D-Ring, and a dorsal attachment D-Ring for fall arrest
- **Adaptability:** Adjustable shoulder and thigh-straps
- **Convenience:** Shoulder and thigh-straps are differentiated by a dual-color scheme
- **Ergonomics:** Ideally positioned sit-strap for extended comfort

Compliance

EN361:2002, SS528:2006



QB-PN-26

QB Full Body Harness

Description

- **Attachment Elements:** A dorsal attachment D-Ring for fall arrest
- **Adaptability:** Adjustable thigh-straps; sliding plates for easy chest-strap adjustment
- **Convenience:** Shoulder and thigh-straps are differentiated by a dual-color scheme
- **Ergonomics:** Ideally positioned sit-strap for extended comfort

Compliance

EN361:2002, SS528:2006



QB-PN-41

QB Full Body Harness

Description

- **Attachment Elements:** 1 dorsal attachment D-Ring for fall arrest and 2 lateral D-Rings for work positioning
- **Adaptability:** Adjustable shoulder, thigh-straps and waist belt; sliding plates for easy adjustment of chest-strap
- **Convenience:** Differentiated shoulder and thigh-straps with a dual-color scheme, plus tool holder loops and rings at the back
- **Ergonomics:** Ideally positioned sit-strap for extended comfort

Compliance

EN361:2002, EN358:1999



QB-PN-56

QB Full Body Harness

Description

- **Attachment Elements:** 1 dorsal and 1 sternal D-Ring for fall arrest, 1 ventral D-Ring at waist level for rope access work, and 2 lateral D-Rings for work positioning, along with 3 tubular gear racks for climbing gear
- **Adaptability:** Adjustable shoulder, thigh-straps, and waist belt
- **Convenience:** Ideal for fall arrest, work positioning, rescue, and rope access applications, featuring lightweight construction with all alloy metal components
- **Ergonomics:** Offers extended comfort with soft padding on the shoulder, waist, and leg straps

Compliance

EN361:2002, EN358:2000, EN813:2008



QB-PN-MAGNA-3

QB Full Body Harness

Description

- **Attachment Elements:** Features 1 dorsal and 1 sternal D-Ring for fall arrest, 1 ventral D-Ring at waist level in front for rope access, and 2 lateral D-Rings at waist level on the sides for work positioning. Equipped with lightweight aluminum D-Rings
- **Adaptability:** Offers adjustable shoulder, thigh-straps, and waist belt
- **Convenience:** Shoulder and thigh-straps feature automatic buckles, the waist strap has combination buckles for easy adjustments. It includes 2 tool holder loops and an extra handle at the back for carrying extra gear, with lanyard keepers on shoulder straps for securing free lanyards
- **Ergonomics:** Designed with ideally positioned elasticated straps for extended comfort, and incorporates specially cushioned mesh netting for superior shock absorption and user comfort

Compliance

EN361:2002, EN358:2000, EN813:2008

QB-PN-309



Single Lanyards with Energy Absorber

Description

- One side hook PN-131
- Other side hook PN-113
- Length: 1.5 meter

Compliance

EN355:2002, SS528:2006

QB-PN-351



Twin Lanyards with Energy Absorber

Description

- Made of 12mm diameter 3 strands twisted polyamide rope
- Equipped with energy absorber PN-300 at one end and two steel scaffold hooks PN-131 at the other end
- Length: 1.5 meters

Compliance

EN355:2002, SS528:2006

QB-PN-341-A



Twin Lanyards with Energy Absorber

Description

- Made of Kernmantle Rope with a diameter of 11mm
- PN 112 with energy absorber PN-300 at one end and two aluminum hooks PN-136 at the other end
- Available in lengths of 1.5 m, 1.8 m, and 2.0 m

Compliance

EN355:2002+VG11/PFE 63 (Additional Static Strength Test), SS528:2006

QB-PN-361



Twin Lanyards with Energy Absorber

Description

- Made of 44mm wide polyester webbing
- PN-113 with energy absorber PN-300 at one end and two steel scaffold hooks PN-131 at the other end
- Length: 1.5 meters

Compliance

EN355:2002+VG11/PFE 63 (Additional Static Strength Test), SS528:2006

QB-PN-01



Work Positioning Belt

Description

- Wide comfort pad that's fully adjustable to provide lumbar support during extended work periods
- Width of back pad: 21 cm
- Two lateral D-Rings for work positioning
- Webbing loops for holding tools and rings for attaching tool holders, belt bags, and more

Compliance

EN358:2000

QB-PN-300



Energy Absorber

Description

- Extends to an additional length of approximately 1.1 meters to 1.2 meters
- Reduces the impact of a fall to less than 6KN

Compliance

EN355:2002

QB-PN-241



Work Positioning Lanyard with Ring Type Adjuster

Description

- 14mm diameter polyamide 3-strand twisted rope with a maximum length of 2.0 meters
- Manual ring-type adjuster forged from alloy steel
- Easy-to-connect steel karabiners (PN-112) at both ends for attachment

Compliance

EN358:2000

QB-PN-242



Work Positioning Lanyard with Grip Adjuster

Description

- Made of 14mm diameter polyamide 3-strand twisted rope
- Features a convenient rope-grab adjuster for easy length adjustment
- Maximum length of 2.0 meters
- Equipped with easy-to-connect steel karabiners (PN-112) at both ends for attachment

Compliance

EN358:2000

QB-PN-209



Restraint Twisted Rope Lanyards

Description

- One side hook PN-131
- Other side hook PN-113
- Length: 1.5 meter

Compliance

EN354:2010

QB-PN-351



PN286(A)(2.0M)

Restraint Lanyards - White

Description

- PN286(A)(2.0M) Restraint System needed at height
- A connecting element or component of an arrest system
- The splices are protected with a sleeve
- With QB-PN-136 aluminum rebar hook

QB-PN-2000C



Rope Grab Fall Arrester

Description

- Works with 14mm & 16mm diameter anchorage lines
- Includes spacing strap and PN-121 hook for attachment
- Fail-safe design ensures proper usage
- Arrests falls within a very short distance
- Detachable - can be easily removed from the anchorage line
- Equipped with a double security locking system

Compliance

EN353-2:2002

QB-PN-910-10m,
QB-PN-920-20m,
QB-PN-930-30m



Twister Rope Anchorage Line

(To be used with QB Fall Arrester)

Description

- Made of 14mm diameter 3-strand polyamide twisted rope
- Features a loop on one side and an end stop knot on the other
- Available in the following lengths
 - 10m - PN-910
 - 20m - PN-920
 - 30m - PN-930

QB-PN-910k-10m,
QB-PN-920k-20m,
QB-PN-930k-30m,
QB-PN-940k-40m,
QB-PN-950k-50m



Kernmantle Rope Anchorage Line

Description

- Made of 11mm diameter Polyamide Kernmantle Rope
- Features a loop on one side and an end stop knot (Also available with loops on both sides)
- Available lengths (longer lengths are available upon request)
 - 10m Ref. Anchor PN 910k (KRKD11)
 - 20m Ref. Anchor PN 920k (KRKD11)
 - 30m Ref. Anchor PN 930k (KRKD11)
 - 40m Ref. Anchor PN 940k (KRKD11)
 - 50m Ref. Anchor PN 950k (KRKD11)

QB-PN-804



Anchorage Webbing Sling

Description

- Constructed with 44mm wide polyester webbing
- Available in a length of 1.5 meters or as per your request
- Equipped with a D-Ring on both ends
- Boasts a minimum strength of 18kN for 3 minutes

Compliance

EN795:2012 Type B

QB-PN-805



Concrete Anchor Strap

Description

- Constructed with 44mm wide polyester webbing
- Available in a length of 1.07 meters or as per your request
- Has a D-Ring at one end, a textile loop at the other, and reinforced load-bearing webbing
- Boasts a minimum strength of 18kN for 3 minutes

QB-PN-806



Concrete Anchor Strap

Description

- Made of 44mm wide polyester webbing with an additional 70mm webbing for extra protection at the back
- Available lengths: 1.0m, 1.5m, 2.0m, or custom length
- Small D-ring at one end, large D-ring at the other
- Boasts a minimum strength of 18kN for 3 minutes

Compliance

EN795:2012 Type B

QB-PN-807



Anchorage Webbing Sling

Description

- Made of 25mm wide polyester webbing
- Length: 0.6 meters, 1.0 meter, and 1.5 meters or as requested
- Boasts a minimum strength of 18kN for 3 minutes

Compliance

EN795:2012 Type B

QB-PN-808



Anchorage Webbing Sling

Description

- Made of 44mm wide polyester webbing
- Length: 20cm to 60cm, or as requested
- Boasts a minimum strength of 18kN for 3 minutes

Compliance

EN795:2012 Type B

QB-PN-814



Anchorage S.S. Wire Rope Sling

Description

- Made of 8.0mm S.S. wire rope
- Length: 1.0 meter, 1.5 meters, 1.8 meters, and 2.0 meters, or as requested
- Includes steel thimbles at both ends for versatile hardware attachment
- Minimum breaking strength: 5000 lbs / 23 kN

Compliance

EN795:2012 Type B

QB-PN-STS-01 (N)



Suspension Trauma Strap

Description

- Highly effective; specially designed to alleviate the negative effects of Suspension Trauma
- Compact and lightweight; doesn't interfere with the worker's activity
- Enables the suspended worker to stand up in their harness to relieve pressure
- Simple attachment to the harness with textile loop and provided Velcro
- Easy deployment; fool-proof operation

Steps to use:



1 Unzip the pouches on both sides of the harness

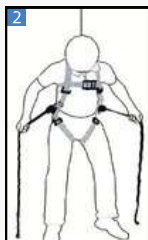

2 Hold the two straps together



3 Connect the straps to create a loop using the user-friendly buckle



4 Place your feet into the loop

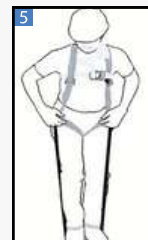

5 Step onto the loop, allowing the thigh straps to move freely



6 Adjust the sit strap forward to relieve pressure and assume a seated posture

QB-PN-111



Steel Quarter Turn Locking Karabiner

Description

- **Material:** Alloy steel
- **Gate opening:** 16mm
- **Minimum breaking strength:** 25kN
- **Available finish:** Golden yellow galvanized
- **Net weight:** 160.5g

Compliance

EN362:2004 Class B

QB-PN-113



Steel Quarter Turn Locking Karabiner

Description

- **Material:** Alloy steel
- **Gate opening:** 22.5mm
- **Minimum breaking strength:** 40kN
- **Finish available:** Golden yellow galvanized
- **Net weight:** 236gm

Compliance

EN362:2004 Class B

QB-PN-114



Steel Triple - Action Locking Karabiner

Description

- **Material:** Alloy steel
- **Gate opening:** 22mm
- **Minimum breaking strength:** 40kN
- **Finish available:** Golden yellow galvanized
- **Net Weight:** 233.4gm

Compliance

EN362:2004 Class B

QB-PN-114C



Steel Triple - Action Locking Karabiner

Description

- **Material:** Alloy steel
- **Gate opening:** 22mm
- **Minimum breaking strength:** 40kN
- **Finish available:** Golden yellow galvanized
- **Net Weight:** 233.4gm

Compliance

EN362:2004 Class B

*Available with captive pin

QB-PN-117F



Aluminium Quarter Turn Locking Karabiner (Forged)

Description

- **Material:** Aluminum alloy
- **Gate opening:** 21mm
- **Minimum breaking strength:** 23kN
- **Finish available:** Coloured, anodized
- **Net Weight:** 84gm

Compliance

EN362:2004 Class B

QB-PN-118F



Aluminium Triple - Action Locking Karabiner

Description

- **Material:** Aluminum alloy
- **Gate opening:** 21mm
- **Minimum breaking strength:** 23KN
- **Finish available:** Coloured, anodized
- **Net Weight:** 79 gm

Compliance

EN362:2004 Class B

*Also available with captive pin on request

QB-PN-SA-11B



Parapet Anchor with Extended Movable Arm

Description

- **Material:** High-strength steel, galvanized for corrosion protection
- **Minimum breaking (System) strength:** 5000lbs/23kN
- **Adjustable flange width** from 60 mm to 360 mm
- **Net Weight:** 9560gms ± 100gms

Compliance

EN795:2012 Type B & ANSI Z359.1:2007

QB-PN-SA-08



Beam Anchor

Description

- **Material:** Aluminum Alloy & Brass
- **Minimum breaking (System) strength:** 5000lbs / 23kN
- **Adjustable flange width** from 90 mm to 340 mm
- **Net Weight:** 1872gms ± 10gms

Compliance

EN795:2012 Type B & ANSI Z359.1:2007

QB-PN-SA-08M



Beam Anchor (Mini)

Description

- **Material:** Aluminum Alloy & Brass
- **Minimum breaking (System) strength:** 5000lbs / 23kN
- Adjustable flange width from 75mm to 150mm
- **Net Weight:** 1560gms ±10gms

Compliance

EN795:2012 Type B & ANSI Z359.1:2007

QB-PN-SA-15



Beam Anchor Trolley

Description

- **Material:** Aluminum & Stainless Steel
- **Minimum breaking (System) strength:** 5000lbs / 23kN
- Adjustable flange width from 80mm to 250mm
- **Length of webbing:** 174mm
- **Net Weight:** 4200gms ±10gms

Compliance

EN795:2012 Type B & ANSI Z359.1:2007

QB-PN-SA-15A



Beam Anchor Trolley

Description

- **Material:** Aluminum & Stainless Steel
- The flanges are adjustable and can be set to widths from 80mm to 250mm
- Anchorage is established by a steel D-ring attached to the trolley bar
- **Minimum breaking (System) strength:** 5000lbs / 23kN
- **Net Weight:** 3900gms ±10gms

Compliance

EN795:2012 Type B & ANSI Z359.1:2007

Cantilever K-Pod

- The new K-Pod offers a safe and reliable system for easy confined space access. It provides overhead anchorage that can be mounted on various bases and is compliant with EN795:2012 Type A standards
- The K-Pod, made of highly corrosion-resistant stainless steel, swivels 360 degrees on its base, offering versatile reach and access
- Its unique feature is the adjustable cantilever arm height at three defined points: upper height adjustment at 2.3m, middle arm adjustment at 1.9m, and lowered arm adjustment at 1.5m, making it suitable for areas with limited roof height
- The K-Pod can be easily mounted on the floor or wall using special brackets. It's also adaptable for mounting on the floor of heavy vehicles, adding to its versatility
- Winch PN-801 can be conveniently attached to the K-Pod using stainless steel fasteners

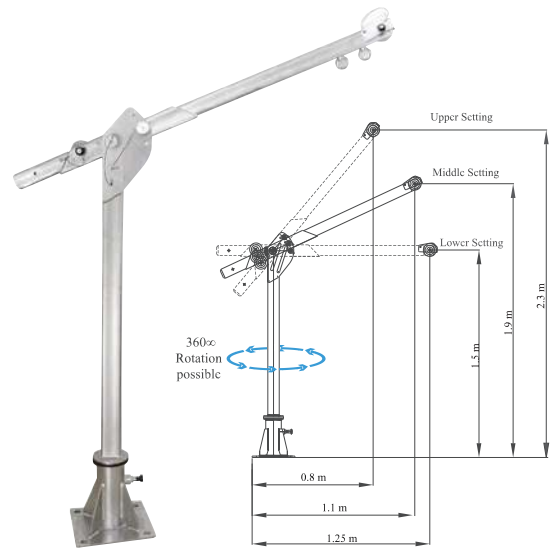

QB-PN-900

Accessories of K-Pod:



Floor Mounting Bracket

QB-PN-900 (01)



Wall Mounting Bracket

QB-PN-900 (02)



Stainless Steel Fasteners
for Winch Mounting

QB-PN-900 (03)

Setting	Distance from bar	Height from bar
Upper	0.8m	2.3m
Lower	1.25m	1.5m

QB-PN-TL-01



Tools Lanyard with Mini Karabiner

Description

- Made of 20mm wide tubular webbing
- Stretch lanyard for tool holding
- Includes a lightweight karabiner for belt attachment
- Supports tools up to 10kg
- **Relaxed length:** 85cm
- **Expanded length:** 135cm

QB Respac Recovery Stretcher

Description

- Resistant to all conditions, body fluids, and blood
- Facilitates safe transport of the wounded
- User-friendly and easy to store
- Offers optimal support and functionality
- Remarkably flexible rescue system
- Exceptionally durable
- Suitable for both vertical and horizontal use

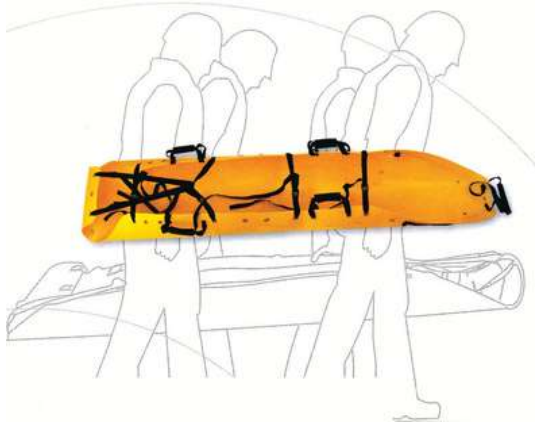

Maximum load: 200kg
Weight of device: 5.5Kg
Total weight with bag and belts: 8Kg

Loading surface

Length: 8ft
Width: 3ft
Material: High Strength Polymer
Hooks (Material): Alloy Steel

Rope

Length: 9m
Diameter: Dia 10mm

Lifting Belts

Length: Feet zone 6.7ft./
Head zone 6.4ft.
Width: Feet zone 5mm/
Head zone 5mm
Maximum load belts: 3000kg
Maximum load stitching: 2000kg

Handles

Material: Polyester
Number of handles on every longitudinal side: 2



QB-PN-403



QB-PN-IMP005 &
QB-PN-IMP005-01

Pilot Chair & Spreader Bar

Description

- Ergonomic and comfortable work chair
- PN111 Steel quarter turn-locking carabiner (sold separately)
- Suitable for vertical ascent and descent
- Spreader bar sold separately and available as an optional accessory

Compliance

EN1498



QB-PN-852

Evacuation Triangle

Description

- Intended for the rescue of injured personnel
- Equipped with 3 metallic D-Rings as attachment elements



QB-PN-MIC02

Micron Block with Hook

Description

- Robust and durable
- Made of 21mm width webbing
- **Maximum length:** 2m
- Features a steel swivel hook (PN-136)
- **Minimum breaking strength:** >15kN
- Equipped with an inbuilt textile energy absorber

Compliance

EN360:2002



QB-PN-2002-SW

Mini Block (Swivel)

Description

- Features a swivel scaffold steel hook (PN-131) at the anchorage end with a fall indicator
- Equipped with retractable webbing that is 47mm wide
- **Maximum length:** 2.5m
- Includes an energy absorber for shock absorption
- Supplied with a steel karabiner (PN-113) at the attachment end
- **Minimum breaking strength:** >15kN
- **Weight:** 1.66 kgs

Compliance

EN360:2002



QB-PN-PCGS-3.5

Retractable Block Polymer Casing with G.I. Wire Rope

Description

- Casing is constructed from high-impact strength polymer to prevent breakage and is nearly indestructible
- Has a load indicator on the PN-162 connector
- Has a PN-113 at one end and a swivel hook (PN-162) at the other
- Swivel hook PN-123 load indicator
- Features a 4.5mm galvanized steel wire rope
- **Minimum breaking strength:** >12kN

Compliance

EN360:2002



QB-PN-PCGS-5

Retractable Block Polymer Casing with G.I. Wire Rope

Description

- Durable high-impact polymer casing prevents breakage
- 4.5mm galvanized steel wire rope included
- Features a PN-162 connector with load indicator at the attachment end
- Equipped with a swiveling anchorage eye to prevent rope twisting during work or falls
- **Minimum breaking strength:** >12kN

Compliance

EN360:2002



QB-PN-PCGS-10

Retractable Block Polymer Casing with G.I. Wire Rope

Description

- High-impact polymer casing for durability and prevention of breakage
- Includes 4.5mm diameter galvanized steel wire rope
- Swiveling anchorage eye prevents rope twisting during work or falls
- **Minimum breaking strength:** >12kN

Compliance

EN360:2002



QB-PN-PCGS-15

Retractable Block Polymer Casing with G.I. Wire Rope

Description

- High-impact polymer casing for durability and prevention of damage
- Includes 4.5mm diameter galvanized steel wire rope
- Equipped with a PN-162 connector featuring a load indicator at the attachment end
- Swiveling anchorage eye prevents rope twisting during work or in the event of a fall
- **Minimum breaking strength:** >12kN

Compliance

EN360:2002



QB-PN-PCGS-20

Retractable Block Polymer Casing with G.I. Wire Rope

Description

- High-impact polymer casing for durability and near-indestructibility
- Features a 4.5mm diameter galvanized steel wire rope
- Equipped with a PN-162 connector with a load indicator at the attachment end
- Swiveling anchorage eye prevents rope twisting during work or in the event of a fall
- **Minimum breaking strength:** >12kN

Compliance

EN360:2002



QB-PN-PCGS-25

Retractable Block Polymer Casing with G.I. Wire Rope

Description

- Durable high-impact polymer casing
- Features a 4.5mm diameter galvanized steel wire rope
- Equipped with a PN-162 connector with a load indicator at the attachment end
- Swiveling anchorage eye prevents rope twisting during work or in the event of a fall
- **Minimum breaking strength:** >12kN

Compliance

EN360:2002



Retractable Block with Retrieval System

QB-PN-PCGS10R

Model	Length of Wire Rope	Weight (Kg)
PCGS10R	10 mtr	5.45 kgs



Retractable Block with Retrieval System

QB-PN-PCGS20R

Model	Length of Wire Rope	Weight (Kg)
PCGS20R	20 mtr	9.2 kgs

Retractable Block with Retrieval System 10mtr (PCGS 10R) & 20mtr (PCGS 20R)

Description

- Features a sleek, slim polymer casing with a convenient side handle and a special grip for easy carrying
- The side locking pin allows independent operation in both Fall Arrest and Winch modes
- Easily mountable on the leg of the Quebee Tripod PN800 using specialized brackets
- **Minimum breaking strength:** >12kN
- Also available with stainless steel wire rope instead of galvanized wire rope

Compliance

EN 360:2002 & EN 1496:2006 Class B

To facilitate the retrieval of a fallen victim, the block enables both fall arrest and easy hoisting using its hoist handle.

Retrieval Fall Arrester Block - In Polymer casing which is coupled with Hoisting Winch

Retractable Block with Retrieval System

Description

- The locking pin allows independent operation in fall arrest and winch modes
- Can be easily mounted on the leg of tripod PN-800A using specialized brackets (Ref. PN-800A/09)
- Minimum breaking strength: >12kN

Compliance

EN 360:2002 & EN 1496:2006 Class B

Model	Length of Wire Rope	Weight (Kg)
PCGS30R	30 mtr	14.5 kgs
PCGS25R	25 mtr	14.1 kgs

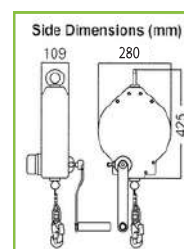

QB-PN-PCGS30R

It is easy to switch between Winch mode and Block mode using the following steps:

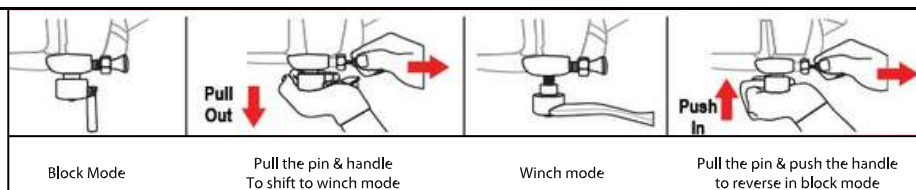

Horizontal 4 Man Temporary Horizontal Rope Anchorage Line (Cross Over)

Offers an easily portable and installable horizontal 4-man temporary lifeline that provides safe and appropriate horizontal anchorage along its entire length.

QB-PN-3001



QB-PN-3001(C)



Description

- Quick and easy to install, and reusable.
- Suitable for up to 4 personnel.
- Features a highly corrosion-resistant tensioner made of aluminum and stainless steel.
- Includes a tension indicator for achieving the appropriate tension in the line.
- The lifeline, made of 16mm diameter Kernmantle rope, has a swivel brass connector at one end, which can be attached to a rated anchor point using a Steel Quarter Turn Locking Karabiner PN 113. The other end is connected with a Karabiner PN 113, linked to the tensioner's eye. The anchorage line is secured at the termination with a stop-knot covered by a protective sleeve.
- Equipped with a Swivel Brass Connector designed to prevent rope twisting.
- The PN-3001 system has 4 Steel O-Rings for attaching the harness lanyard to the lifeline using a Karabiner.
- The PN-3001(C) system features 4 Cross Over Steel Anchors (SA 29) made of stainless steel for easy user crossovers and to prevent disengagement from the lifeline, ensuring 100% tie-off at all times.
- Total line length is 25m, covering a span of 5m to 25m.
- Minimum Breaking Strength: 25kN.
- The entire system is supplied in a bag permanently attached to the assembly, which also facilitates easy transport with comfortable handles. The bag is designed to keep the unused rope safe, preventing abrasion or damage from dust, dirt, grime, oil, etc. Once fitted, you can easily store the extra undeployed rope back into the bag.

Compliance

EN 795:2012 Type C & TS 16415 2013 Type C

Horizontal Anchorage Lifeline

Description

- The Horizon PN-3000 is a 30mm polyester webbing lifeline with a Quebee ratchet tensioner for easy tensioning between structures. It features auto-locking steel karabiners (Our Ref PN-113) at both ends.
- The entire system is supplied in a bag that is permanently attached to the assembly and includes comfortable shoulder hanging straps for user-friendly transport.
- Once installed, you can conveniently stow away the extra webbing not deployed along the length inside the bag.
- Available in a total length of 20 meters, allowing users to utilize it for lengths ranging from 5 meters to 20 meters.
- Tested and certified for use by two users simultaneously.



QB-PN-3000

Compliance

EN795:1996 Class B

Tripod

Description

- Designed for confined space access
- Features two head-mounted pulleys for cable passage
- Features two auxiliary eye bolts for attachment points
- Made of aluminum alloy cast head and legs
- Steel support shoes with rubber soles for stability
- Anchorage point strength exceeds 12kN
- Each tripod includes a built-in fixture for attaching our winch PN-801 (removable upon request)
- Comes with a tripod bag, Ref. No. PN-904 (7ft), for convenient storage and transport

Length	Specification	Compliance
7 ft	<ul style="list-style-type: none"> • Telescopic legs, height adjustable from 1.15m to 2.15m • Wheelbase (Footprint): 1.5m in diameter • Weight: 13kg • Maximum load capacity: 500kg 	EN795 Class B
10 ft	<ul style="list-style-type: none"> • Telescopic legs, height adjustable from 1.9m to 2.9m • Wheelbase (Footprint): 1.8m in diameter • Weight: 15kg • Maximum load capacity: 500kg 	



QB-PN-800 (7ft)



QB-PN-904 (7ft)



QB-PN-800 (10ft)

Winch QB-PN-801-20

Description

- Designed for raising or lowering personnel or materials into confined spaces
- Secure fixture for tripod PN-800
- **Lifting load capacity:** 135 kgs
- **Length:** 20.0m
- Can be attached to Quebee K-pod PN-900
- Designed for use with a retractable fall arrester when raising or lowering a person
- Also available with stainless steel (SS) wire rope, with references PN 801(20)SS and PN-801(25)SS

Compliance	EN1496:2006 (Class A)
------------	-----------------------



Winch

Winch QB-PN-801-40

Description

- Designed for raising or lowering personnel or materials into confined spaces
- Equipped with a bolting fixture for secure attachment to winches PN 801(40)
- Maximum lifting load capacity according to EN 1496: 135 kg
- Maximum lifting load capacity as per Machinery Directive 2006/42/EC: 250 kg
- Features a Screw Locking Karabiner (PN 112) as a connector
- Designed for use with a Retractable Fall Arrester when raising or lowering a person
- Suitable to Quebee K-Pod PN 900
- Available with stainless steel (SS) wire rope as PN 801(40)SS

Compliance	EN1496:2006 (Class A)
------------	-----------------------



Ref. No	Length
QB-PN-801-20	20 mtr
QB-PN-801-40	40 mtr