

Quebee

SAFETY PRODUCTS CATALOGUE





HEAD PROTECTION

 Quebee



QB-AQM2

Colour



QB Safety Helmet

Description

- A super lightweight and durable helmet designed for optimal impact resistance
- Made from high-density polyethylene or ABS material for strength and longevity
- Offers excellent comfort with a six-point suspension system, providing perfect impact protection
- Features a versatile universal slot that adapts to most accessories, allowing for easy customization

Compliance

CE EN397, SS98

P3

QB-LR-P3- AQM2-RAT

Description

- Plastic suspension with wheel ratchet headband adjustment for AQM2



QB-AQM3

Colour



QB Safety Helmet

Description

- Universally favored design widely accepted at all levels of industry.
- A super lightweight and durable helmet designed for optimal impact resistance.
- Made from high-density polyethylene material for strength and longevity.
- Offers excellent comfort with a six-point suspension system, providing perfect impact protection.

Compliance

CE EN397, SS98

P7

QB-LR-P7-AQM3-RAT

Description

- Webbing suspension with wheel ratchet headband adjustment for AQM3



P8

QB-LR-P8-AQM3-SLIP

Description

- Plastic suspension with slip ratchet headband adjustment for AQM3





QB-AQM8



Colour



P12

QB-LR-P12-AQM8-RAT

- Webbing suspension with wheel ratchet head band adjustment for AQM8

QB Safety Helmet

Description

- Revolutionary design that seamlessly combines comfort, performance, and style
- Reduced peak for enhanced visibility and optimal vision while working at heights
- Adaptable to various accessories effortlessly with the versatile universal slot
- Secure and customizable fit ensured by the six-point double nape stripe and convenient wheel ratchet
- Made from high-density polyethylene material for strength and longevity

Compliance

CE EN397, SS98



QB-AS-P4

P4

- Sweatband



QB-AS-P5

P5

- Elastic chin strap with chin cup



Black
QB-BC-SC01SS-BK



Navy Blue
QB-BC-SC02SS-NB



Grey
QB-BC-SC03SS-GE



Navy Blue
(Short Peak)
QB-BC-SC02SV-NB

Quebee Spear Baseball Cap

Description

- Versatile color options to suit various workplace environments
- Weighs approximately 170 grams, providing a lightweight and comfortable experience
- The external fabric is securely fitted to the shell using Velcro, ensuring a secure and snug fit
- Enhanced visibility with reflective tape for increased safety in low-light conditions

Compliance

CE EN812/A1



EYE PROTECTION

 Quebee



QB-SG5903-CLR

Anti-Fog

QB Chemical Goggle

Description

- Impact resistance against high-speed particles at extreme temperatures.
- Protection against UV radiation.
- Indirect ventilation design for protection against liquids, dust, gases, and vapors.
- Excellent field of view for enhanced safety and can be worn over most prescription spectacles.
- Broad, fully adjustable headbands for optimal fit and reliable protection.
- General design with a flexible nose bridge for improved comfort.
- Optical Class 1 lens provides the clearest and most panoramic view without obstruction.

Compliance

ANSI Z87.1, CE EN166



QB-HY-YZ-2-AF

Anti-Fog

QB Chemical Goggle

Description

- Lightweight goggle with indirect ventilation for comfort and breathability.
- Ideal protection against dust, impact, and chemical splash.
- Using 100% polycarbonate lenses that offer high impact scratch resistance while filtering out over 99.9% of harmful UV radiation.
- Soft and flexible vinyl frame.

Compliance

CE EN166



QB-1910-K-HC-CLR-AF

Anti-Fog



QB-1910-K-HC-IO

QB Viggen 1910-K

Description

- One-piece lens with dual 9.75 base curvature, snugly fits all face types and offers full eye-protection against high impact.
- Optical Class 1 lens provides the clearest and most panoramic view without obstruction.
- Using 100% polycarbonate lenses that offer high impact scratch resistance while filtering out over 99.9% of harmful UV radiation.
- Modern co-material temple design with soft temple tips for enhanced comfort.
- Suitable for various working environments.

Compliance

ANSI Z87.1, AS/NZS 1337.1/ CE EN166



QB-2245-CLR-AF-KIT



QB-2245-IO-AF-KIT



QB-2245-IO /
QB-2245-CLR



QB-2245-F1



QB-2245-HB1

QB Shark 2245

Description

- Lightweight sporty design delivers reliable performance.
- Close-fitting, unitary front with dual 9.5 base curved lens offers wide and unobstructed vision.
- Durable co-injected 3 position tilt angle adjustable temples provide user maximum comfort.
- Soft nose pads prevent slipping while providing a pillow soft fit.
- Optional foam gasket and headband.
- Optical class one lens filters out 99.9% harmful UV radiation.

Compliance

ANSI Z87.1, CE EN166

Lens & Temper Color Options

1. Clear AF Lens with Black Polycarbonate / Lime TPR Temper
2. IO AF Lens with Gray Polycarbonate / Sapphire TPR Temper



QB-9301-CLR



QB-9301-IO

QB Hawk 9301

Description

- Model sporty design allows safety glasses to give a wider product semantics in addition to providing protection.
- Length and angle adjustable temples
- Soft nose pad provides non-slip fitting.
- Stylish and non-slip temple design with soft tips offers sung fitting for all day use.
- Polycarbonate lens filters out 99.9% of harmful UV light.

Compliance

ANSI Z87.1, CE EN166



QB-SS-7724-SMK



QB-SS-7724-CLR



QB-SS-7724-HC-IO

QB Zoom 7724

Description

- Close-fitting, unitary front with dual 9.5 base curved lens offers wide and unobstructed vision.
- Using 100% polycarbonate lenses that offer high impact scratch resistance while filtering out over 99.9% of harmful UV radiation.
- Universal bridge fits almost all face contours.
- Fashionable design, suitable for both men & women.

Compliance

ANSI Z87.1

QB Skyraider 2048



QB-2048-CLR

Description

- Full front, side, and top (brow) protection.
- Using 100% polycarbonate lenses that offer high impact scratch resistance while filtering out over 99.9% of harmful UV radiation.
- Can be worn over most prescription frames.
- Suitable for everyday use as safety eyewear.
- Optical Class 1 lens provides the clearest and most panoramic view without obstruction.

Compliance

ANSI Z87.1, CE EN166

QB Python S21



QB-S21-HC-CLR-AF

Description

- Close-fitting design offers wide and unobstructed vision.
- Using 100% polycarbonate lenses that offer high impact scratch resistance while filtering out over 99.9% of harmful UV radiation.
- Fashionable design with a soft Asian nose bridge, suitable for both Asian men and women.
- Stylish co-injection temples resembling sunglasses.
- Lightweight and comfortable for all-day use.

Compliance

ANSI Z87.1, CE EN166



QB-2101-HC-SMK



QB-2101-HC-CLR-AF



QB-2101-HC-IO

QB Phoenix 2101

Description

- Close-fitting with 8 base curved lens offers wide and unobstructed vision
- Semi-frame with direct ventilation system help reducing possible fogging
- Slim temple design with 4 position temple length adjustment provides great fitting for users
- Sleeve in soft nose pieces provides snug fitting
- Using 100% polycarbonate lenses that offer high impact scratch resistance while filtering out over 99.9% of harmful UV radiation.

Compliance

ANSI Z87.1, CE EN166



QB-5064-HC-CLR-AF

QB Raven Visitor 5064

Description

- Using 100% polycarbonate lenses that offer high impact scratch resistance while filtering out over 99.9% of harmful UV radiation.
- Compact overspec with 5-curved lens design offers full front, side, and top protection that can be assembled with prescription lenses.
- Soft earpiece provides a secure and comfortable fit.

Compliance

ANSI Z87.1, CE EN166



QB-5900-HC-SMK



QB-5900-HC-CLR



QB-5900-HC-IO

QB Phantom 5900

Description

- Using 100% polycarbonate lenses that offer high impact scratch resistance while filtering out over 99.9% of harmful UV radiation.
- Close-fitting design offers wide and unobstructed vision.
- Universal bridge fits almost all face contours.
- Ultra lightweight and comfortable for all-day use.

Compliance

ANSI Z87.1, CE EN166



QB-SG511-1-DB-CLR



QB-SG511-1-DB-SMK

QB Raider SG511

Description

- Combines fashion, style, and a lightweight design to provide a wide and unobstructed vision.
- Using 100% polycarbonate lenses that offer high impact scratch resistance while filtering out over 99.9% of harmful UV radiation.
- Adjustable temple length allows for a customized fit to suit your head.
- Available frame colors include dark blue, red/white/blue, and yellow/black/yellow.
- Lens color options consist of clear and smoke.

Compliance

ANSI Z87.1, CE EN166-F



QB-5400-TA10-HC-CLR

QB Harrier 5400

Description

- Using 100% polycarbonate lenses that offer high impact scratch resistance while filtering out over 99.9% of harmful UV radiation.
- Overspec designed to offer full front, side, and top protection that can be assembled with prescription lenses.
- Optical Class 1 lens provides the clearest and most panoramic view without obstruction.
- Features a ratchet angle adjustable temple.
- Adjustable temple length allows for a customized fit to suit your head.

Compliance

ANSI Z87.1, CE EN166



RESPIRATORY PROTECTION

 Quebee



QB-910I-N95 / QB-910IS-N95

QB N95 Particulate Respirator

Description

- Comfortable to wear and easy to use
- Lightweight for comfort and longer wear time
- Offers a cost-effective protection solution
- Available in two sizes to ensure a proper facial fit
- Adjustable nose clip for a secure, custom-fit
- Reduces the potential for eyewear fogging
- Provides 95% filter efficiency when subjected to a 0.3µm particle challenge
- Shell is designed to resist collapse in hot and humid conditions
- State-of-the-art filter media provides low-resistance filtration

Compliance

NIOSH N95



HEARING PROTECTION

 Quebee

Quebee Reusable Earplugs corded and uncorded With carrying case



**Uncorded Reusable Earplug
with carrying case**

EC-2018A

Description

Quebee Silicon reusable Earplugs offer SNR 33dB and NRR 26dB attenuation protection. This new translucent Christmas tree 3-layer design increases user comfort and protection. The high-visibility stem allows for one-handed insertion and easy visibility from a distance for compliance.

Comfortable

- Made of pure silicon material for low pressure inside the ear
- Reusable and maintains its shape even after extended use
- Resistant to humidity and sweat, helping prevent moisture buildup in the ear canal
- The 3-layer design allows for a secure fit in the ear canal
- Designed to fit the majority of ear canals, providing premium comfort and protection

Convenient

- The Christmas tree design fits most ear canals, making the plugs easier to use

Compatibility

- Designed to be compatible with earmuffs or other PPE

Tested according to EN352-2:2002 and ANSI S3.19-1974 standards

Attenuation Data H-34dB M-30dB L-27dB

ANSI S3.19-1974

NRR 26dB

Frequency (HZ)	125	250	500	1000	2000	4000	8000	SNR
Mean Attenuation (dB)	30.8	27.7	30.8	34.7	36.9	37.1	44.0	33dB
Standard Deviation (dB)	3.8	4.1	4.3	3.2	3.5	4.3	4.5	
APV (dB)	27.1	23.6	26.5	31.5	33.4	32.8	39.5	



**Corded Reusable Earplug
with carrying case**

EC-2018A-C

Quebee Disposable Earplugs

Description

Quebee PU Foam Earplugs offer SNR 37dB and NRR 33dB attenuation protection. The new tapered shape and premium memory PU ensure increased user comfort and protection.

Comfortable

- ▶ Soft PU foam material for low pressure inside the ear
- ▶ Slow rebound rate allows for a full attachment to the ear canal
- ▶ Designed to fit the majority of ear canals with premium comfort and protection

Convenient

- ▶ Bullet design fits most ear canals, making the plugs easier to use



**Uncorded
Disposable Earplug**

EC-1003A



**Corded
Disposable Earplug**

EC-1003A

ANSI S3.19-1974

NRR 33dB

Tested according to EN352-2:2020 standards
Attenuation Data H-37dB M-35dB L-30dB

Frequency (HZ)	125	250	500	1000	2000	4000	8000	SNR
Mean Attenuation (dB)	28.7	32.2	39.6	40.5	37.9	42.2	46.3	37dB
Standard Deviation (dB)	3.6	5.2	5.4	4.3	2.9	3.1	5.4	
APV (dB)	25.1	27.0	34.2	36.2	35.0	39.1	40.9	



EM-5002A

Headband Earmuff

Description

- Headband Earmuff with soft foam-filled cushions
- Lightweight ear cups
- PU-covered headband for extended comfort
- Provides a good seal with high noise reduction

Compliance

CE EN352-1:2020, SNR 34dB
H=36dB, M=32dB, L=24dB
ANSI S3.19-1974, NRR 27dB



EM-5002B

Headband & Foldable Earmuff

Description

- Foldable Headband Earmuff with soft foam-filled cushions
- Lightweight ear cups
- Padded headband for extended comfort
- Provides a good seal with high noise reduction

Compliance

CE EN352-1:2020, SNR 33dB
H=35dB, M=32dB, L=23dB
ANSI S3.19-1974, NRR 26dB



EM-5002C

Neckband Earmuff

Description

- Neckband Earmuff with soft foam-filled cushions
- Lightweight ear cups
- Provides a good seal with high noise reduction

Compliance

CE EN352-1:2002, SNR 31dB
H=33dB, M=29dB, L=22dB



EM-5002D

Helmet attachable Earmuff

Description

- Helmet Attachable Earmuff with soft foam-filled cushions
- Lightweight ear cups
- Provides a good seal with high noise reduction

Compliance

CCE EN352-3:2002, SNR 30dB
H=31dB, M=28dB, L=21dB
ANSI S3.19-1974, NRR 22dB



HAND PROTECTION

Quebee



QB-VSPF-DISP

QB Vinyl Synthetic Glove

Description

- Latex-free, thereby preventing allergic responses
- Ambidextrous, fits either hand
- Beaded cuff for easy on and off
- Powder-free gloves help prevent particulate contamination
- Excellent fit and comfort
- Isolate hands from biological hazards while providing very good overall protection



QB-OCPFNFK-EXAM

QB Examination Nitrile Powder free Glove

Description

- Made from 100% nitrile, 0.13 mm thick, and 24 cm long
- Feature a beaded cuff for added convenience
- These gloves are ambidextrous, fitting for either hand
- Meet an acceptable quality level of AQL1.5
- Comply with FDA food handling requirements (21 CFR 177.2600)



QB-VERGE-700-L1



Verge 700

Description

- Made of nylon yarn with a black NBR foam palm
- Cut level 1
- Excellent grip on wet/slightly oily surfaces
- Durable, breathable, and abrasion-resistant

Compliance

EN388:2003



QB-VERGE-1000-L1



Verge 1000

Description

- Excellent grip & dexterity
- Strong resistance to oil & chemicals
- Exceptional comfort & breathability
- Heavy duty NBR foam coated glove

Compliance

EN388:2003



QB-VERGE-2300-L3



Verge 2300

Description

- Made of seamless HPPE yarn with black NBR foam palm
- Cut level 3
- Excellent grip on wet/slightly oily surfaces
- Durable, breathable, and abrasion-resistant

Compliance

EN388:2003



QB-VERGE-2500-L5



Verge 2500

Description

- Made of seamless HPPE and glassfiber yarn with black NBR foam palm
- Cut level 5
- Excellent grip on wet/slightly oily surfaces
- Durable, breathable, and abrasion-resistant

Compliance

EN388:2003



QB-VERGE-7517-L5



Verge 7515

Description

- High-performance Aramid/steel cut and heat resistance
- Strong liner coating adhesion
- Exceptional comfort and breathability

Applications

- Versatile for automotive assembly, engine/transmission assembly, metal stamping and assembly, motorized equipment handling, construction, glass handling, and aerospace.

Compliance

EN388:2003



QB-VERGE-8000-L1



Verge 8000

Verge 8000 is a versatile NBR-coated glove for excellent grip on slightly oily, smooth items, and added comfort for small objects.

Description

- Excellent grip & dexterity
- Excellent abrasion resistant
- Strong resistance to oil
- Exceptional comfort and breathability
- Available in 8/M, 9/L & 10/XL sizes

Applications

- Versatile for electricity component assembly and installation, small part handling, logistics and warehouse handling, quality inspection, construction, gardening, and agriculture.

Compliance

EN 388:2016



QB-VERGE-9300-L3



Verge 9300

Verge 9300 offers excellent cut resistance and grip for handling slightly oily, smooth objects, with added comfort for handling small items.

Description

- Excellent high-performance polyethylene cut-resistant liner
- Strong coating adhesion
- Exceptional comfort and breathability
- Available in 7/S, 8/M, 9/L & 10/XL sizes

Applications

Versatile for automotive, engine/transmission assembly, metal stamping, motorized equipment handling, construction, glass handling, and aerospace.

Compliance

EN 388:2016



QB-VERGE-9500-L5



Verge 9500

Verge 9500 is a cut-resistant NBR-coated glove for excellent grip on slightly oily, smooth objects, with added comfort for small items.

Description

- Excellent high-performance polyethylene cut-resistant liner
- Strong coating adhesion
- Exceptional comfort and breathability
- Available in 8/M, 9/L & 10/XL sizes

Applications

Versatile for automotive assembly, engine/transmission assembly, metal stamping & assembly, motored equipment handling, construction, glass handling & aerospace.

Compliance

EN 388:2016



QB-VERGETACTICAL

Verge TACTICAL

Description

- Durable synthetic leather double-palm
- Reinforced thumb panel for added durability
- Breathing holes between fingers
- 2-way stretch spandex material provides maximum comfort

Compliance

EN 388 CE Directive 89/686/EEC



QB-VERGEPRO-BK



Verge PRO

Description

- Excellent grip and dexterity
- Anti-slip, waterproof, and oil-proof patches on palm and finger
- Kevlar protection at junction of palm and index finger for increased grip and fire-resistant
- 4mm foam lining at the knuckle with plastic protection injected

Compliance

EN 388 CE Directive 89/686/EEC



QB-VERGEMAXX



Verge Maxx

Description

- Protects workers from hazards such as abrasion, cuts, punctures, vibration, and impact
- The padding under the palm absorbs vibrations, and the sandy nitrile foam-coated palm provides excellent grip in both dry and wet conditions
- TPR Big Panels are stitched on the knuckles and lower part of the gloves for impact protection

Compliance

EN 388 CE Directive 89/686/EEC



QB-VERGETOUCH-BK



Verge TOUCH

Description

- Touchscreen-compatible fingertip
- Durable synthetic leather double palm
- Reinforced thumb panel for added durability
- Breathing holes between fingers
- 2-way stretch spandex material provides maximum comfort
- 4mm foam lining at knuckle with plastic protection injected

Compliance

EN 388 CE Directive 89/686/EEC



QB-VERGEPLUS-YF



Verge PLUS

Description

- Excellent grip and anti-slip properties
- Anti-slip, waterproof, and oil-proof patches on the palm and fingers
- Bright, luminous green and orange plastic identification in dim light
- 4mm foam lining at the knuckles with injected plastic protection

Compliance

EN 388 CE Directive 89/686/EEC



QB-KP138-81714/
QB-KP138-81718

Quebee Kevlar / Leather Heat Resistance Glove

Description

- Featuring leather and Kevlar-reinforced palms
- Providing excellent abrasion and cut protection.
- Available in lengths of 14" and 18"
- Heat protection ranging from 600°F to 800°F



QB-RB305-BK

Quebee Industrial Rubber Gloves

Description

- Made from natural rubber latex as a raw material
- Enhanced with additives for comfort and convenience.
- Available in black, with lengths of 12", 18", and 24"



QB-ASC06-59001-BU

QB Vinyl Sleeves

Description

- A full 18-inch sleeve, 8 mil
- Vinyl styles are heat-sealed without exposed elastic
- Excellent protection against chemicals, snags, punctures, and abrasions



PROTECTIVE APPAREL

Quebee

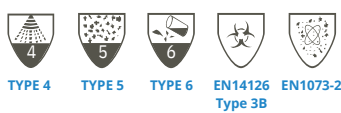

QB-5026-356D



QB MicroPz Disposable Chemical Coverall

Description

- Breathable
- Electrostatic dissipative
- Antibacterial
- Protects against solid particles, liquid chemicals, infectious agents, and radioactive particles.

QB Tecasafe Plus FR Garments

- Inherently flame-resistant, the fabric maintains FR properties through washing and wear while ensuring comfort and moisture management
- The fabric maintains durability, abrasion resistance, and like-new appearance even after washes
- Excellent value with a long life cycle and competitive pricing
- Designs include jackets, pants, and coveralls, with color options such as orange and navy blue, or other colors available upon request
- Surpasses performance standards of NFPA 70E HRC1, HRC2, and NFPA 2112



TECASAFE Overall Chart Sizes

QB-TCS580-CL-NB / QB-TCS580-CL-OR

Size	S	M	L	XL	2XL	3XL	4XL	5XL
Shoulder	17.5"	18.5"	19.5"	20.5"	21.5"	22.5"	23.5"	24"
Chest	40"	42"	44"	46"	48"	50"	52"	54"
Waist (After Elastic)	35"	37"	39"	41"	43"	45"	47"	49"
Body Length	18.5"	19"	19.5"	20"	20.5"	21"	21.5"	22"
Length of Pant	39"	40"	41"	42"	43"	43"	44"	44"

TECASAFE Jacket Chart Sizes

QB-TCS580-JK-NB / QB-TCS580-JK-OR

Size	S	M	L	XL	2XL	3XL	4XL	5XL
Shoulder	17.5"	18.5"	19.5"	20.5"	21.5"	22.5"	23"	23.5"
Chest	39"	41"	43"	45"	47"	49"	51"	53"
Sleeve	22.5"	23"	23.5"	24"	24.5"	25"	25.5"	26"
Waist	38"	40"	42"	44"	46"	48"	50"	52"
Length	25.5"	26"	27"	28"	29"	29.5"	30"	30.5"

TECASAFE Pants Chart Sizes

QB-TCS580-PT-NB / QB-TCS580-PT-OR

Size	S	M	L	XL	2XL	3XL	4XL	5XL
Waist	28"	30"	32"	34"	36"	38"	40"	42"
Length	38.5"	39.5"	40.5"	41.5"	42.5"	43"	43.5"	44"



Photos are for illustration purposes only.
Actual colors may vary

QB Fire Fighting Suit, Jacket/Coat

- ▶ Upright collar closed with Velcro tabs that can be turned down
- ▶ Chest pocket on the jackets equipped with radio and microphone pockets
- ▶ The front closure uses a brass zipper concealed by a Velcro-sealed plate
- ▶ Cuff with inner ribbed sleeve to prevent fire incursion
- ▶ 3M Scotchlite Reflective Tapes installed to enhance high visibility



QB-UXF-X6-968-NB

QB Fire Fighting Suit, Trouser

- ▶ Two large front flapped pockets
- ▶ Flapped bellow pocket on each leg
- ▶ Leg cuffs with leather trimming
- ▶ 3M Scotchlite Reflective Tapes installed to enhance high visibility

Outer Shelf: 6.0oz Nomex IIIA; 93% Nomex/5% Kevlar /2% P140; Twill Weave (200 gm)

Moisture Barrier: 70% Conex/30% Twaron Laminated to FR PTFE Membrane (70gm)

Thermal Felt: 95% Nomex/5% Kevlar (150gm)

Lining: 50% Nomex/50% FR Viscose (130gm)

Reflective Tape: 3M Scotchlite Fluorescent Line-Yellow Fire Coated

Color: Navy Blue

Packaging: 1 suit per bag

Sizes: M, L & XL Only (other sizes on request)

Compliance

EN 340:2003, EN 469: 2005

* Quebee Fire Fighting suits feature a multi-layer design using Nomex as the outer shell, with a CONEX & TWARON moisture barrier and insulating thermal barrier lining

QB Firefighter Glove

Outer Shelf: 6.0oz Nomex IIIA; 93% Nomex / 5% kevlar / 2% P140; Twill Weave (200gm)

Moisture Barrier: 70% Conex/30% Twaron Laminated to FR PTFE Membrane (70gm)

Thermal Felt: 95% Nomex / 5% Kevlar (150gm)

Lining: 50% Nomex / 50% FR Viscose (130gm)

Reflective tape: 3M Scotchlite fluorescent line-yellow fire coated tape

Color: Navy blue

Packaging: 1 pair/poly bag

Sizes: M & L only



QB-UNX-S07-II-NB

Flame Resistance (Coverall / Jacket & Pants) Protective Apparels

Quebee Flame Resistance (QFR) garments are constructed from a blend of 98% cotton and 2% Anti-static fabrics, offering the durability of cotton while ensuring softness and comfort. Despite their gentle texture and pleasant feel against the skin, Quebee QFR garments are highly durable due to their strong abrasion resistance.

QFR garments provide limited protection in the event of a flash fire or electric arc flash, aiming to minimize damage to the body and provide essential seconds to move away from the hazard. They serve two primary functions: slowing the transfer of heat through the fabric and insulating the body against the heat source, while also self-extinguishing and ceasing to burn when the flame or heat source is removed.



Quebee Flame Resistance (Coverall)

QB-QFR-CL-NB/QB-QFR-CL-OR

Quebee Flame Resistance (Jacket & Pants)

QB-QFR-JK-NB/QB-QFR-JK-OR
QB-QFR-PT-NB/QB-QFR-PT-OR

Specifications

Fabric Material: FR Cotton Treated. 98% cotton and 2% Anti-Static

Type & Weight: Twill 220 gsm

Wash Count: 50 wash

Colour: Orange & Navy Blue in

Design: Jackets & Pants and Coverall

Reflective Tape: 2 inches Silver Flame Resistant Reflective Tape

Compliances

EN ISO 11612:2015: Protection against Industrial Heat and Flame Hazards

EN ISO 11611:2015: Protection against Welding Hazards

EN 1149-5:2008: Electrostatic Properties according to Charge Decay Method



QB-BSA300-56411



QB Heavy Duty Neoprene Apron

Description

- Made from 19oz. heavy-duty black neoprene
- Offers versatile protection against various chemicals
- Sizes: 35" x 43"
- Thickness: 22 mils
- Color: Black



QB-BEA06-R-54441



QB Regular Duty Vinyl Apron

Description

- Premium Quality Industrial Apron
- Made from high-quality vinyl
- Blends flexibility with chemical, fat, oil, and puncture resistance
- Sizes: 35" X 48"
- Thickness: 7.5 mils
- Color: Blue



QB-BSA500-460-54742



QB Heavy Duty Vinyl Apron

Description

- Made from heavy-duty vinyl
- Offers excellent resistance to chemicals, fats, oils, grease, punctures, and abrasion
- Sizes: 35" x 45"
- Thickness: 20 mils
- Color: Green



QB-BSA900-56910



QB Vinyl Coat Apron

Description

- Made from high-quality vinyl with dielectrically welded seams for chemical resistance and front protection
- Full sleeves with elastic wrists enhance arm protection
- Suitable for electronics manufacturing, labs, and cleanrooms, handling various chemicals
- Size: 51" X 27"
- Thickness: 8 mils
- Color: Blue



FALL PROTECTION

 Quebee



QB-PN-11

QB Full Body Harness

Description

- **Attachment Elements:** A dorsal attachment D-Ring for fall arrest
- **Adaptability:** Adjustable thigh-straps; sliding plates for easy chest-strap adjustment
- **Convenience:** Shoulder and thigh-straps are differentiated by a dual-color scheme
- **Ergonomics:** Ideally positioned sit-strap for extended comfort

Compliance

EN361:2002, SS528:2006



QB-PN-23

QB Full Body Harness

Description

- **Attachment Elements:** 2 shoulder attachment D-Rings, 1 chest attachment D-Ring, and a dorsal attachment D-Ring for fall arrest
- **Adaptability:** Adjustable shoulder and thigh-straps
- **Convenience:** Shoulder and thigh-straps are differentiated by a dual-color scheme
- **Ergonomics:** Ideally positioned sit-strap for extended comfort

Compliance

EN361:2002, SS528:2006



QB-PN-26

QB Full Body Harness

Description

- **Attachment Elements:** A dorsal attachment D-Ring for fall arrest
- **Adaptability:** Adjustable thigh-straps; sliding plates for easy chest-strap adjustment
- **Convenience:** Shoulder and thigh-straps are differentiated by a dual-color scheme
- **Ergonomics:** Ideally positioned sit-strap for extended comfort

Compliance

EN361:2002, SS528:2006



QB-PN-41

QB Full Body Harness

Description

- **Attachment Elements:** 1 dorsal attachment D-Ring for fall arrest and 2 lateral D-Rings for work positioning
- **Adaptability:** Adjustable shoulder, thigh-straps and waist belt; sliding plates for easy adjustment of chest-strap
- **Convenience:** Differentiated shoulder and thigh-straps with a dual-color scheme, plus tool holder loops and rings at the back
- **Ergonomics:** Ideally positioned sit-strap for extended comfort

Compliance

EN361:2002, EN358:1999



QB-PN-56

QB Full Body Harness

Description

- **Attachment Elements:** 1 dorsal and 1 sternal D-Ring for fall arrest, 1 ventral D-Ring at waist level for rope access work, and 2 lateral D-Rings for work positioning, along with 3 tubular gear racks for climbing gear
- **Adaptability:** Adjustable shoulder, thigh-straps, and waist belt
- **Convenience:** Ideal for fall arrest, work positioning, rescue, and rope access applications, featuring lightweight construction with all alloy metal components
- **Ergonomics:** Offers extended comfort with soft padding on the shoulder, waist, and leg straps

Compliance

EN361:2002, EN358:2000, EN813:2008



QB-PN-MAGNA-3

QB Full Body Harness

Description

- **Attachment Elements:** Features 1 dorsal and 1 sternal D-Ring for fall arrest, 1 ventral D-Ring at waist level in front for rope access, and 2 lateral D-Rings at waist level on the sides for work positioning. Equipped with lightweight aluminum D-Rings
- **Adaptability:** Offers adjustable shoulder, thigh-straps, and waist belt
- **Convenience:** Shoulder and thigh-straps feature automatic buckles, the waist strap has combination buckles for easy adjustments. It includes 2 tool holder loops and an extra handle at the back for carrying extra gear, with lanyard keepers on shoulder straps for securing free lanyards
- **Ergonomics:** Designed with ideally positioned elasticated straps for extended comfort, and incorporates specially cushioned mesh netting for superior shock absorption and user comfort

Compliance

EN361:2002, EN358:2000, EN813:2008

QB-PN-309



Single Lanyards with Energy Absorber

Description

- One side hook PN-131
- Other side hook PN-113
- Length: 1.5 meter

Compliance

EN355:2002, SS528:2006

QB-PN-351



Twin Lanyards with Energy Absorber

Description

- Made of 12mm diameter 3 strands twisted polyamide rope
- Equipped with energy absorber PN-300 at one end and two steel scaffold hooks PN-131 at the other end
- Length: 1.5 meters

Compliance

EN355:2002, SS528:2006

QB-PN-341-A



Twin Lanyards with Energy Absorber

Description

- Made of Kernmantle Rope with a diameter of 11mm
- PN 112 with energy absorber PN-300 at one end and two aluminum hooks PN-136 at the other end
- Available in lengths of 1.5 m, 1.8 m, and 2.0 m

Compliance

EN355:2002+VG11/PFE 63 (Additional Static Strength Test), SS528:2006

QB-PN-361



Twin Lanyards with Energy Absorber

Description

- Made of 44mm wide polyester webbing
- PN-113 with energy absorber PN-300 at one end and two steel scaffold hooks PN-131 at the other end
- Length: 1.5 meters

Compliance

EN355:2002+VG11/PFE 63 (Additional Static Strength Test), SS528:2006

QB-PN-01



Work Positioning Belt

Description

- Wide comfort pad that's fully adjustable to provide lumbar support during extended work periods
- Width of back pad: 21 cm
- Two lateral D-Rings for work positioning
- Webbing loops for holding tools and rings for attaching tool holders, belt bags, and more

Compliance

EN358:2000

QB-PN-300



Energy Absorber

Description

- Extends to an additional length of approximately 1.1 meters to 1.2 meters
- Reduces the impact of a fall to less than 6KN

Compliance

EN355:2002

QB-PN-241



Work Positioning Lanyard with Ring Type Adjuster

Description

- 14mm diameter polyamide 3-strand twisted rope with a maximum length of 2.0 meters
- Manual ring-type adjuster forged from alloy steel
- Easy-to-connect steel karabiners (PN-112) at both ends for attachment

Compliance

EN358:2000

QB-PN-242



Work Positioning Lanyard with Grip Adjuster

Description

- Made of 14mm diameter polyamide 3-strand twisted rope
- Features a convenient rope-grab adjuster for easy length adjustment
- Maximum length of 2.0 meters
- Equipped with easy-to-connect steel karabiners (PN-112) at both ends for attachment

Compliance

EN358:2000

QB-PN-209



Restraint Twisted Rope Lanyards

Description

- One side hook PN-131
- Other side hook PN-113
- Length: 1.5 meter

Compliance

EN354:2010

QB-PN-351



PN286(A)(2.0M)

Restraint Lanyards - White

Description

- PN286(A)(2.0M) Restraint System needed at height
- A connecting element or component of an arrest system
- The splices are protected with a sleeve
- With QB-PN-136 aluminum rebar hook

QB-PN-2000C



Rope Grab Fall Arrester

Description

- Works with 14mm & 16mm diameter anchorage lines
- Includes spacing strap and PN-121 hook for attachment
- Fail-safe design ensures proper usage
- Arrests falls within a very short distance
- Detachable - can be easily removed from the anchorage line
- Equipped with a double security locking system

Compliance

EN353-2:2002

QB-PN-910-10m,
QB-PN-920-20m,
QB-PN-930-30m



Twister Rope Anchorage Line

(To be used with QB Fall Arrester)

Description

- Made of 14mm diameter 3-strand polyamide twisted rope
- Features a loop on one side and an end stop knot on the other
- Available in the following lengths
 - 10m - PN-910
 - 20m - PN-920
 - 30m - PN-930

QB-PN-910k-10m,
QB-PN-920k-20m,
QB-PN-930k-30m,
QB-PN-940k-40m,
QB-PN-950k-50m



Kernmantle Rope Anchorage Line

Description

- Made of 11mm diameter Polyamide Kernmantle Rope
- Features a loop on one side and an end stop knot (Also available with loops on both sides)
- Available lengths (longer lengths are available upon request)
 - 10m Ref. Anchor PN 910k (KRKD11)
 - 20m Ref. Anchor PN 920k (KRKD11)
 - 30m Ref. Anchor PN 930k (KRKD11)
 - 40m Ref. Anchor PN 940k (KRKD11)
 - 50m Ref. Anchor PN 950k (KRKD11)

QB-PN-804



Anchorage Webbing Sling

Description

- Constructed with 44mm wide polyester webbing
- Available in a length of 1.5 meters or as per your request
- Equipped with a D-Ring on both ends
- Boasts a minimum strength of 18kN for 3 minutes

Compliance

EN795:2012 Type B

QB-PN-805



Concrete Anchor Strap

Description

- Constructed with 44mm wide polyester webbing
- Available in a length of 1.07 meters or as per your request
- Has a D-Ring at one end, a textile loop at the other, and reinforced load-bearing webbing
- Boasts a minimum strength of 18kN for 3 minutes

QB-PN-806



Concrete Anchor Strap

Description

- Made of 44mm wide polyester webbing with an additional 70mm webbing for extra protection at the back
- Available lengths: 1.0m, 1.5m, 2.0m, or custom length
- Small D-ring at one end, large D-ring at the other
- Boasts a minimum strength of 18kN for 3 minutes

Compliance

EN795:2012 Type B

QB-PN-807



Anchorage Webbing Sling

Description

- Made of 25mm wide polyester webbing
- Length: 0.6 meters, 1.0 meter, and 1.5 meters or as requested
- Boasts a minimum strength of 18kN for 3 minutes

Compliance

EN795:2012 Type B

QB-PN-808



Anchorage Webbing Sling

Description

- Made of 44mm wide polyester webbing
- Length: 20cm to 60cm, or as requested
- Boasts a minimum strength of 18kN for 3 minutes

Compliance

EN795:2012 Type B

QB-PN-814



Anchorage S.S. Wire Rope Sling

Description

- Made of 8.0mm S.S. wire rope
- Length: 1.0 meter, 1.5 meters, 1.8 meters, and 2.0 meters, or as requested
- Includes steel thimbles at both ends for versatile hardware attachment
- Minimum breaking strength: 5000 lbs / 23 kN

Compliance

EN795:2012 Type B

QB-PN-STS-01 (N)



Suspension Trauma Strap

Description

- Highly effective; specially designed to alleviate the negative effects of Suspension Trauma
- Compact and lightweight; doesn't interfere with the worker's activity
- Enables the suspended worker to stand up in their harness to relieve pressure
- Simple attachment to the harness with textile loop and provided Velcro
- Easy deployment; fool-proof operation

Steps to use:



1 Unzip the pouches on both sides of the harness

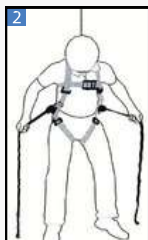

2 Hold the two straps together



3 Connect the straps to create a loop using the user-friendly buckle



4 Place your feet into the loop

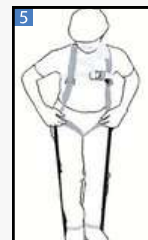

5 Step onto the loop, allowing the thigh straps to move freely



6 Adjust the sit strap forward to relieve pressure and assume a seated posture

QB-PN-111



Steel Quarter Turn Locking Karabiner

Description

- **Material:** Alloy steel
- **Gate opening:** 16mm
- **Minimum breaking strength:** 25kN
- **Available finish:** Golden yellow galvanized
- **Net weight:** 160.5g

Compliance

EN362:2004 Class B

QB-PN-113



Steel Quarter Turn Locking Karabiner

Description

- **Material:** Alloy steel
- **Gate opening:** 22.5mm
- **Minimum breaking strength:** 40kN
- **Finish available:** Golden yellow galvanized
- **Net weight:** 236gm

Compliance

EN362:2004 Class B

QB-PN-114



Steel Triple - Action Locking Karabiner

Description

- **Material:** Alloy steel
- **Gate opening:** 22mm
- **Minimum breaking strength:** 40kN
- **Finish available:** Golden yellow galvanized
- **Net Weight:** 233.4gm

Compliance

EN362:2004 Class B

QB-PN-114C



Steel Triple - Action Locking Karabiner

Description

- **Material:** Alloy steel
- **Gate opening:** 22mm
- **Minimum breaking strength:** 40kN
- **Finish available:** Golden yellow galvanized
- **Net Weight:** 233.4gm

Compliance

EN362:2004 Class B

*Available with captive pin

QB-PN-117F



Aluminium Quarter Turn Locking Karabiner (Forged)

Description

- **Material:** Aluminum alloy
- **Gate opening:** 21mm
- **Minimum breaking strength:** 23kN
- **Finish available:** Coloured, anodized
- **Net Weight:** 84gm

Compliance

EN362:2004 Class B

QB-PN-118F



Aluminium Triple - Action Locking Karabiner

Description

- **Material:** Aluminum alloy
- **Gate opening:** 21mm
- **Minimum breaking strength:** 23KN
- **Finish available:** Coloured, anodized
- **Net Weight:** 79 gm

Compliance

EN362:2004 Class B

*Also available with captive pin on request

QB-PN-SA-11B



Parapet Anchor with Extended Movable Arm

Description

- **Material:** High-strength steel, galvanized for corrosion protection
- **Minimum breaking (System) strength:** 5000lbs/23kN
- **Adjustable flange width** from 60 mm to 360 mm
- **Net Weight:** 9560gms ± 100gms

Compliance

EN795:2012 Type B & ANSI Z359.1:2007

QB-PN-SA-08



Beam Anchor

Description

- **Material:** Aluminum Alloy & Brass
- **Minimum breaking (System) strength:** 5000lbs / 23kN
- **Adjustable flange width** from 90 mm to 340 mm
- **Net Weight:** 1872gms ± 10gms

Compliance

EN795:2012 Type B & ANSI Z359.1:2007

QB-PN-SA-08M



Beam Anchor (Mini)

Description

- **Material:** Aluminum Alloy & Brass
- **Minimum breaking (System) strength:** 5000lbs / 23kN
- Adjustable flange width from 75mm to 150mm
- **Net Weight:** 1560gms ±10gms

Compliance

EN795:2012 Type B & ANSI Z359.1:2007

QB-PN-SA-15



Beam Anchor Trolley

Description

- **Material:** Aluminum & Stainless Steel
- **Minimum breaking (System) strength:** 5000lbs / 23kN
- Adjustable flange width from 80mm to 250mm
- **Length of webbing:** 174mm
- **Net Weight:** 4200gms ±10gms

Compliance

EN795:2012 Type B & ANSI Z359.1:2007

QB-PN-SA-15A



Beam Anchor Trolley

Description

- **Material:** Aluminum & Stainless Steel
- The flanges are adjustable and can be set to widths from 80mm to 250mm
- Anchorage is established by a steel D-ring attached to the trolley bar
- **Minimum breaking (System) strength:** 5000lbs / 23kN
- **Net Weight:** 3900gms ±10gms

Compliance

EN795:2012 Type B & ANSI Z359.1:2007

Cantilever K-Pod

- The new K-Pod offers a safe and reliable system for easy confined space access. It provides overhead anchorage that can be mounted on various bases and is compliant with EN795:2012 Type A standards
- The K-Pod, made of highly corrosion-resistant stainless steel, swivels 360 degrees on its base, offering versatile reach and access
- Its unique feature is the adjustable cantilever arm height at three defined points: upper height adjustment at 2.3m, middle arm adjustment at 1.9m, and lowered arm adjustment at 1.5m, making it suitable for areas with limited roof height
- The K-Pod can be easily mounted on the floor or wall using special brackets. It's also adaptable for mounting on the floor of heavy vehicles, adding to its versatility
- Winch PN-801 can be conveniently attached to the K-Pod using stainless steel fasteners

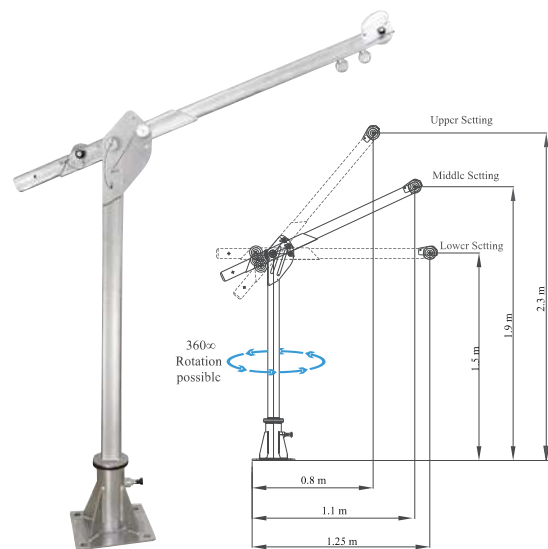

QB-PN-900

Accessories of K-Pod:



Floor Mounting Bracket

QB-PN-900 (01)



Wall Mounting Bracket

QB-PN-900 (02)

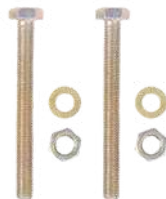

Stainless Steel Fasteners
for Winch Mounting

QB-PN-900 (03)

Setting	Distance from bar	Height from bar
Upper	0.8m	2.3m
Lower	1.25m	1.5m

QB-PN-TL-01



Tools Lanyard with Mini Karabiner

Description

- Made of 20mm wide tubular webbing
- Stretch lanyard for tool holding
- Includes a lightweight karabiner for belt attachment
- Supports tools up to 10kg
- **Relaxed length:** 85cm
- **Expanded length:** 135cm

QB Respac Recovery Stretcher

Description

- Resistant to all conditions, body fluids, and blood
- Facilitates safe transport of the wounded
- User-friendly and easy to store
- Offers optimal support and functionality
- Remarkably flexible rescue system
- Exceptionally durable
- Suitable for both vertical and horizontal use

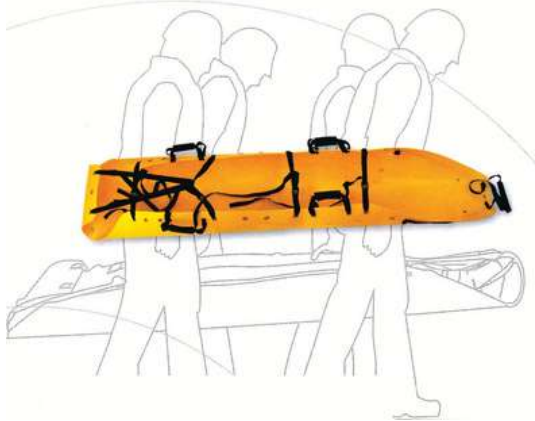

Maximum load: 200kg
Weight of device: 5.5Kg
Total weight with bag and belts: 8Kg

Loading surface

Length: 8ft
Width: 3ft
Material: High Strength Polymer
Hooks (Material): Alloy Steel

Rope

Length: 9m
Diameter: Dia 10mm

Lifting Belts

Length: Feet zone 6.7ft./
Head zone 6.4ft.
Width: Feet zone 5mm/
Head zone 5mm
Maximum load belts: 3000kg
Maximum load stitching: 2000kg

Handles

Material: Polyester
Number of handles on every longitudinal side: 2



QB-PN-403



QB-PN-IMP005 &
QB-PN-IMP005-01

Pilot Chair & Spreader Bar

Description

- Ergonomic and comfortable work chair
- PN111 Steel quarter turn-locking carabiner (sold separately)
- Suitable for vertical ascent and descent
- Spreader bar sold separately and available as an optional accessory

Compliance

EN1498



QB-PN-852

Evacuation Triangle

Description

- Intended for the rescue of injured personnel
- Equipped with 3 metallic D-Rings as attachment elements



QB-PN-MIC02

Micron Block with Hook

Description

- Robust and durable
- Made of 21mm width webbing
- **Maximum length:** 2m
- Features a steel swivel hook (PN-136)
- **Minimum breaking strength:** >15kN
- Equipped with an inbuilt textile energy absorber

Compliance

EN360:2002



QB-PN-2002-SW

Mini Block (Swivel)

Description

- Features a swivel scaffold steel hook (PN-131) at the anchorage end with a fall indicator
- Equipped with retractable webbing that is 47mm wide
- **Maximum length:** 2.5m
- Includes an energy absorber for shock absorption
- Supplied with a steel karabiner (PN-113) at the attachment end
- **Minimum breaking strength:** >15kN
- **Weight:** 1.66 kgs

Compliance

EN360:2002



QB-PN-PCGS-3.5

Retractable Block Polymer Casing with G.I. Wire Rope

Description

- Casing is constructed from high-impact strength polymer to prevent breakage and is nearly indestructible
- Has a load indicator on the PN-162 connector
- Has a PN-113 at one end and a swivel hook (PN-162) at the other
- Swivel hook PN-123 load indicator
- Features a 4.5mm galvanized steel wire rope
- **Minimum breaking strength:** >12kN

Compliance

EN360:2002



QB-PN-PCGS-5

Retractable Block Polymer Casing with G.I. Wire Rope

Description

- Durable high-impact polymer casing prevents breakage
- 4.5mm galvanized steel wire rope included
- Features a PN-162 connector with load indicator at the attachment end
- Equipped with a swiveling anchorage eye to prevent rope twisting during work or falls
- **Minimum breaking strength:** >12kN

Compliance

EN360:2002



QB-PN-PCGS-10

Retractable Block Polymer Casing with G.I. Wire Rope

Description

- High-impact polymer casing for durability and prevention of breakage
- Includes 4.5mm diameter galvanized steel wire rope
- Swiveling anchorage eye prevents rope twisting during work or falls
- **Minimum breaking strength:** >12kN

Compliance

EN360:2002



QB-PN-PCGS-15

Retractable Block Polymer Casing with G.I. Wire Rope

Description

- High-impact polymer casing for durability and prevention of damage
- Includes 4.5mm diameter galvanized steel wire rope
- Equipped with a PN-162 connector featuring a load indicator at the attachment end
- Swiveling anchorage eye prevents rope twisting during work or in the event of a fall
- **Minimum breaking strength:** >12kN

Compliance

EN360:2002



QB-PN-PCGS-20

Retractable Block Polymer Casing with G.I. Wire Rope

Description

- High-impact polymer casing for durability and near-indestructibility
- Features a 4.5mm diameter galvanized steel wire rope
- Equipped with a PN-162 connector with a load indicator at the attachment end
- Swiveling anchorage eye prevents rope twisting during work or in the event of a fall
- **Minimum breaking strength:** >12kN

Compliance

EN360:2002



QB-PN-PCGS-25

Retractable Block Polymer Casing with G.I. Wire Rope

Description

- Durable high-impact polymer casing
- Features a 4.5mm diameter galvanized steel wire rope
- Equipped with a PN-162 connector with a load indicator at the attachment end
- Swiveling anchorage eye prevents rope twisting during work or in the event of a fall
- **Minimum breaking strength:** >12kN

Compliance

EN360:2002



Retractable Block with Retrieval System

QB-PN-PCGS10R

Model	Length of Wire Rope	Weight (Kg)
PCGS10R	10 mtr	5.45 kgs



Retractable Block with Retrieval System

QB-PN-PCGS20R

Model	Length of Wire Rope	Weight (Kg)
PCGS20R	20 mtr	9.2 kgs

Retractable Block with Retrieval System 10mtr (PCGS 10R) & 20mtr (PCGS 20R)

Description

- Features a sleek, slim polymer casing with a convenient side handle and a special grip for easy carrying
- The side locking pin allows independent operation in both Fall Arrest and Winch modes
- Easily mountable on the leg of the Quebee Tripod PN800 using specialized brackets
- **Minimum breaking strength:** >12kN
- Also available with stainless steel wire rope instead of galvanized wire rope

Compliance

EN 360:2002 & EN 1496:2006 Class B

To facilitate the retrieval of a fallen victim, the block enables both fall arrest and easy hoisting using its hoist handle.

Retrieval Fall Arrester Block - In Polymer casing which is coupled with Hoisting Winch

Retractable Block with Retrieval System

Description

- The locking pin allows independent operation in fall arrest and winch modes
- Can be easily mounted on the leg of tripod PN-800A using specialized brackets (Ref. PN-800A/09)
- Minimum breaking strength: >12kN

Compliance

EN 360:2002 & EN 1496:2006 Class B

Model	Length of Wire Rope	Weight (Kg)
PCGS30R	30 mtr	14.5 kgs
PCGS25R	25 mtr	14.1 kgs

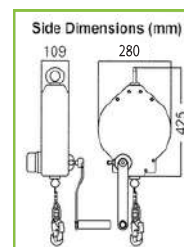

QB-PN-PCGS30R

It is easy to switch between Winch mode and Block mode using the following steps:

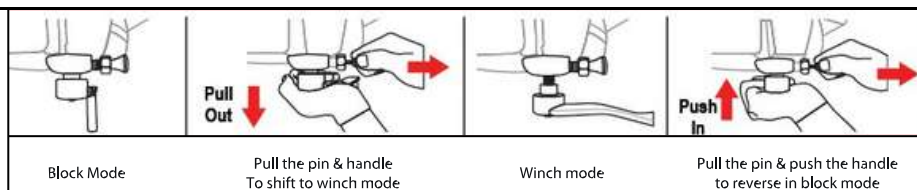

Horizontal 4 Man Temporary Horizontal Rope Anchorage Line (Cross Over)

Offers an easily portable and installable horizontal 4-man temporary lifeline that provides safe and appropriate horizontal anchorage along its entire length.

QB-PN-3001



QB-PN-3001(C)



Description

- Quick and easy to install, and reusable.
- Suitable for up to 4 personnel.
- Features a highly corrosion-resistant tensioner made of aluminum and stainless steel.
- Includes a tension indicator for achieving the appropriate tension in the line.
- The lifeline, made of 16mm diameter Kernmantle rope, has a swivel brass connector at one end, which can be attached to a rated anchor point using a Steel Quarter Turn Locking Karabiner PN 113. The other end is connected with a Karabiner PN 113, linked to the tensioner's eye. The anchorage line is secured at the termination with a stop-knot covered by a protective sleeve.
- Equipped with a Swivel Brass Connector designed to prevent rope twisting.
- The PN-3001 system has 4 Steel O-Rings for attaching the harness lanyard to the lifeline using a Karabiner.
- The PN-3001(C) system features 4 Cross Over Steel Anchors (SA 29) made of stainless steel for easy user crossovers and to prevent disengagement from the lifeline, ensuring 100% tie-off at all times.
- Total line length is 25m, covering a span of 5m to 25m.
- Minimum Breaking Strength: 25kN.
- The entire system is supplied in a bag permanently attached to the assembly, which also facilitates easy transport with comfortable handles. The bag is designed to keep the unused rope safe, preventing abrasion or damage from dust, dirt, grime, oil, etc. Once fitted, you can easily store the extra undeployed rope back into the bag.

Compliance

EN 795:2012 Type C & TS 16415 2013 Type C

Horizontal Anchorage Lifeline

Description

- The Horizon PN-3000 is a 30mm polyester webbing lifeline with a Quebee ratchet tensioner for easy tensioning between structures. It features auto-locking steel karabiners (Our Ref PN-113) at both ends.
- The entire system is supplied in a bag that is permanently attached to the assembly and includes comfortable shoulder hanging straps for user-friendly transport.
- Once installed, you can conveniently stow away the extra webbing not deployed along the length inside the bag.
- Available in a total length of 20 meters, allowing users to utilize it for lengths ranging from 5 meters to 20 meters.
- Tested and certified for use by two users simultaneously.



QB-PN-3000

Compliance

EN795:1996 Class B

Tripod

Description

- Designed for confined space access
- Features two head-mounted pulleys for cable passage
- Features two auxiliary eye bolts for attachment points
- Made of aluminum alloy cast head and legs
- Steel support shoes with rubber soles for stability
- Anchorage point strength exceeds 12kN
- Each tripod includes a built-in fixture for attaching our winch PN-801 (removable upon request)
- Comes with a tripod bag, Ref. No. PN-904 (7ft), for convenient storage and transport

Length	Specification	Compliance
7 ft	<ul style="list-style-type: none"> • Telescopic legs, height adjustable from 1.15m to 2.15m • Wheelbase (Footprint): 1.5m in diameter • Weight: 13kg • Maximum load capacity: 500kg 	EN795 Class B
10 ft	<ul style="list-style-type: none"> • Telescopic legs, height adjustable from 1.9m to 2.9m • Wheelbase (Footprint): 1.8m in diameter • Weight: 15kg • Maximum load capacity: 500kg 	



QB-PN-800 (7ft)



QB-PN-904 (7ft)



QB-PN-800 (10ft)



Winch QB-PN-801-20

Description

- Designed for raising or lowering personnel or materials into confined spaces
- Secure fixture for tripod PN-800
- **Lifting load capacity:** 135 kgs
- **Length:** 20.0m
- Can be attached to Quebee K-pod PN-900
- Designed for use with a retractable fall arrester when raising or lowering a person
- Also available with stainless steel (SS) wire rope, with references PN 801(20)SS and PN-801(25)SS

Compliance	EN1496:2006 (Class A)
------------	-----------------------



Winch

Winch QB-PN-801-40

Description

- Designed for raising or lowering personnel or materials into confined spaces
- Equipped with a bolting fixture for secure attachment to winches PN 801(40)
- Maximum lifting load capacity according to EN 1496: 135 kg
- Maximum lifting load capacity as per Machinery Directive 2006/42/EC: 250 kg
- Features a Screw Locking Karabiner (PN 112) as a connector
- Designed for use with a Retractable Fall Arrester when raising or lowering a person
- Suitable to Quebee K-Pod PN 900
- Available with stainless steel (SS) wire rope as PN 801(40)SS

Compliance	EN1496:2006 (Class A)
------------	-----------------------



Ref. No	Length
QB-PN-801-20	20 mtr
QB-PN-801-40	40 mtr



FOOT PROTECTION

 Quebee

QB Safety PVC Boots



QB-102-21-B/Y



QB-102-21-Y/B

Description

- Virgin PVC material
- Steel toe cap and steel midsole
- Sole pattern effectively channels out debris
- Kick-off lug for easy removal
- Roomy toe & metatarsal area for extra comfort
- Wider sloping malleolar zone for easy donning and squatting
- Cut-off bands reduce chafing when the boot is shortened
- Height: 360 to 375mm

- Sole pattern effectively channels out debris
- Kick off lug for easy removal
- Roomy toe & metatarsal area for extra comfort
- Cut-off bands reduce chafing when the boot is shortened

Compliance

CE EN20345:2004

QB Economy PVC Boots

Description

- Sole pattern effectively channels out debris
- Kick-off lug for easy removal
- Roomy toe & metatarsal area for extra comfort
- Wider sloping malleolar zone for easy donning and squatting
- Cut-off bands reduce chafing when the boot is shortened



QB-102-23-B/B



QB-102-23-W/W

Compliance

CE EN ISO20345:2004

QB-K8920-VISTA



Vista Laced-up Safety Shoes

Description

- Black buffalo grain tango leather
- Dual-density PU sole
- Black EVA insole
- Black non-woven lining
- Steel toe cap and steel midsole

Compliance

CE EN ISO 20345:2011, SS513:2005

QB-S8600-VESTA



Vesta Slip-on Safety Shoes

Description

- Black buffalo grain tango leather
- Dual-density PU sole
- Black EVA insole
- Black non-woven lining
- Steel toe cap and steel midsole

Compliance

CE EN ISO 20345:2011, SS513:2005

QB-K8801



Xenic Lace-up Ankle Boots

Description

- Black buffalo grain tango leather
- Dual-density PU sole
- Black EVA insole
- Black non-woven lining
- Steel toe cap and steel midsole

Compliance

CE EN ISO 20345:2011, SS513:2005



SPILL CONTROL MANAGEMENT

 **Quebee**



QB-KIT-CHEM-2

QB Emergency Spill Control Kit

Content

- 2 rolls of folded chemical sorbent
- 25 pieces of chemical sorbent pads
- 1 disposable coverall
- 1 pair of safety chemical goggles
- 1 set of half-mask respirator with cartridges
- 1 pair of chemical gloves
- 3 disposable bags and cable ties
- 1 pair of boot cover
- 1 yellow mobile cart with Quebee logo
- 1 copy of the hazardous spill clean-up manual



QB-KIT-CHEM-3

QB Spill Response PPE Kit

Content

- 1 roll folded chemical sorbent
- 1 pc of disposable coverall
- 1 pc of safety chemical goggle
- 1 set of half mask respiratory w/cartridges
- 1 pair of chemical gloves
- 1 pair of chemical resistant PVC boots
- 1 disposable bag and cable ties
- 1 plastic container with handle



QB-KIT-CHEM-4

QB Emergency Spill Control Kit

Content

- 2 rolls of Quebee chemical folded sorbent
- 25 pcs of Quebee chemical sorbent pads
- 1 pc of Quebee MicroPz disposable coverall
- 1 pair of safety chemical goggles
- 1 set of half-mask respiratory with cartridges
- 1 pair of chemical gloves
- 3 pcs of disposable bags and cable ties
- 1 pair of boot covers
- 1 yellow mobile cart with Quebee logo
- 1 copy of the hazardous spill clean-up manual



QB-KIT-CHEM-6

QB Buddy Emergency Spill Control Kits

Content

- 1 pc gallon Overpack salvage drum
- 25 pcs Chemical Absorbent Pad
- 6 pcs Chemical Absorbent Boom
- 5 pcs Chemical Sorbent Pillow
- 2 pairs Tyvek Booties
- 2 pcs Disposable Chemical Suit
- 2 pcs Safety Goggles
- 2 pairs Safety Gloves
- 3 pcs Chemical Disposal PE Bags
- 3 pcs Cable Ties
- 1 copy of the hazardous spill clean-up manual

Chemical Absorbent Folded Roll

Description

- Size: 11cm x 18m x 3mm
- Capacity: 119 liters/case
- Packing: 3 rolls/case



QB-CR-9000-XLH9118

Chemical Absorbent Pads

Description

- Size: 40cm x 50m x 4mm
- Capacity: 1145 liters/case
- Packing: 100 pcs/case

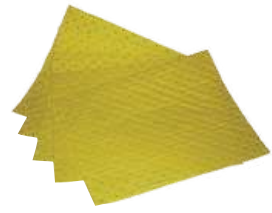

QB-CD-9000-PSY91401

Chemical Absorbent Boom

Description

- Size: 7.6cm x 1.2m
- Capacity: 78 liters/case
- Packing: 12pcs/case



QB-CB-9000-Y781

Chemical Extra Perforated Absorbent Rolls

Description

- Size: 40cm x 18m x 3mm
- Capacity: 119 liters/case
- Packing: 1roll/case



QB-CR-9000-XLH4020

Petroleum Absorbent Boom

Description

- Size: 7.6 cm x 2.1 m
- Capacity: 78 liters/case
- Packing: 12 pcs/case



QB-PD-9100-W781

Chemical Absorbent Pillow

Description

- Size: 25cm x 35cm
- Capacity: 72 liters/case
- Packing: 20pcs/case



QB-CP-9000-Y425

Petroleum Absorbent Pads

Description

- Size: 40cm x 50cm x 4mm
- Capacity: 145 liters/case
- Packing: 100pcs/case



QB-PD-9100-PS1401

Petroleum Absorbent Folded Roll

Description

- Size: 11cm x 18m x 3mm
- Capacity: 119 liters/case
- Packing: 3 rolls/case



QB-PR-9100-XL118

Petroleum Absorbent Roll

Description

- Size: 80cm x 30m x 4mm
- Capacity: 153 liters/case
- Packing: 1roll/case



QB-PR-9100-PS2402

Universal Absorbent Folded Roll

Description

- Size: 11cm x 18m x 3mm
- Capacity: 119 liters/case
- Packing: 3 rolls/case



QB-UR-9200-XL9118



OTHER

 **Quebee**

Quebee Fire Blanket

Description

QUEBEE Fire Blankets are widely utilized in residential, commercial, and industrial locations, serving as an excellent fire protection tool, particularly in kitchens and workspaces.

Technical Specifications:

- **Fabric Material:** Glass Fibre
- **Fabric Weight:** 430g/m²
- **Fabric Thickness:** 0.43mm
- **Fabric Colour:** White
- **Weave Method:** Twilling Weave
- **Temp. Resistance:** 500°C
- **Packing:** Red Plastic Box
- **Standard Comply:** BS EN : 1869

The blankets are made of woven glass fiber fabric in a satin weave, i.e., smooth, soft, and tightly woven, which protects against skin irritation. The fabric thickness is only 0.43mm, making it easy to wrap around uneven surfaces. It provides an effective outer layer of protection against unwanted contact with heat.



QB-3900-FB44

Model	Blanket Size	Box Size (L x W x H)	Weight
QB-3900-FB44-4X4	1.2m x 1.2m	4ft x 4ft	0.7kg
QB-3900-FB44-4X6	1.2m x 1.8m	4ft x 6ft	0.8kg
QB-3900-FB44-6X6	1.8m x 1.8m	6ft x 6ft	1.2kg

The Fire Blankets are each packed in a compact hard plastic box for ease of storage and handling. Mounting holes are also provided for wall hanging.

QB Surgical 3-Ply Mask

Description

- Without Glass Fibers
- Hypoallergenic
- Low Breathing Resistance
- Adaptable Nose Bar
- High Filtration Capacity
- Perfect Fit



QB-CN102-3P

Conformity

- BFE >98%
- EN14683
- American ASTM F2100 Level 2
- Cytotoxicity: ISO 10993-5:2009(E)
- Sensitization: ISO 10993-10:2002/AMD 1:2010
- Irritation: ISO 10993-10:2002/AMD 1:2010
- A HSA Registered Product



